

# Adj. Kit for Cable Cross Over 2.0 (freestanding) (KB06MI-079)

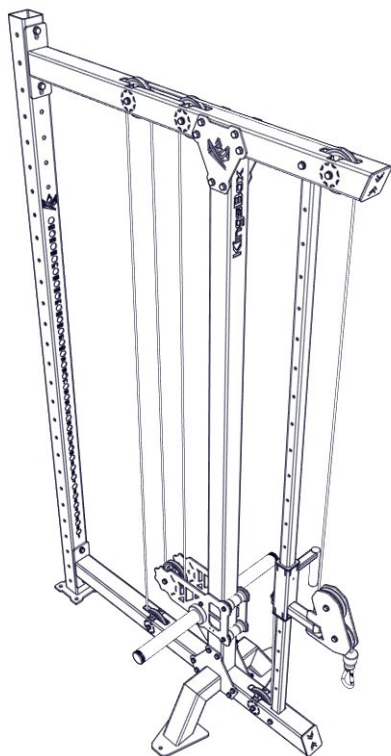

**KingsBox®**  
BUILDING BETTER HUMANS

**Manufacturer:**

Kingsbox d.o.o.  
Partizanska 129, 6210 Sežana  
Slovenia

**Customer service:**

Write us on ***info@kingsbox.com*** or send us a message through our website at ***www.kingsbox.com/help***

**Usage class:**

Studio (S)

**Designed in compliance with:**

ISO 20957

**Warnings:**

- Freestanding equipment shall be installed on a stable and levelled base
- All equipment designed with anchoring/attachement holes (e.g. rigs, racks, equipment and accessories for racks, storage pins/shelves, etc.) should be securely screwed to the fixed ground/wall/structure through all the designated fixing holes and with appropriate sized screws.
- Injuries to health may result from incorrect or excessive training
- Keep unsupervised children away from the equipment

**Maximum training mass** <sup>(1)</sup>: 80 kg or 40 kg/sleeve

<sup>(1)</sup> Training mass - achieved through different means of resistance (weight plates, stacked weights, dumbbells, elastic cords, etc.), excluding user's bodyweight.

**WARNING!**

**If the structure (rig/rack) onto which this equipment is attached, is not secured to the ground and / or to the wall, it may overturn and / or cause damage to person or object in the immediate vicinity.**

The fixing bolts for wall and / or floor are not included in the package, since different types of anchor bolts must be used for different wall / floor types.

# Assembly elements:



**Position 1**

**Upright 1x**

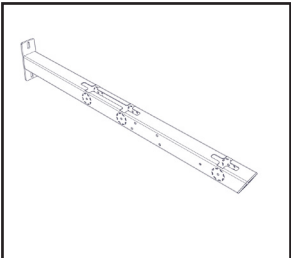

**Position 2**

**CCO Adj. Pulley Pro-  
file UP 1x**

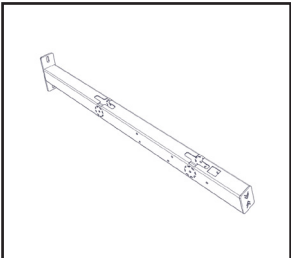

**Position 3**

**CCO Adj. Pulley Pro-  
file BOTTOM 1x**

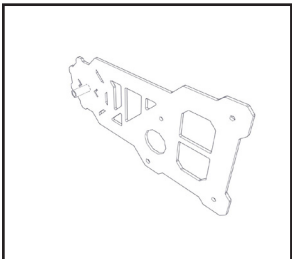

**Position 4**

**Pulley Cart 2.0 Plate  
LH 1x**

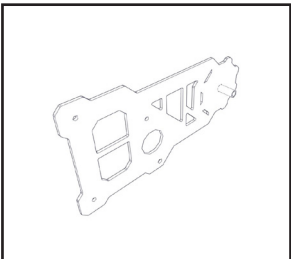

**Position 5**

**Pulley Cart 2.0 Plate  
RH 1x**

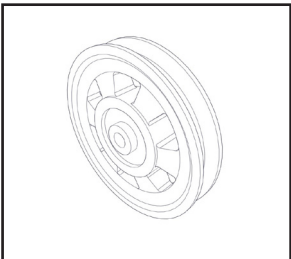

**Position 6**

**Pulley 114mm 7x**

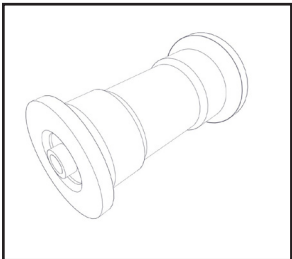

**Position 7**

**Roller 3x**

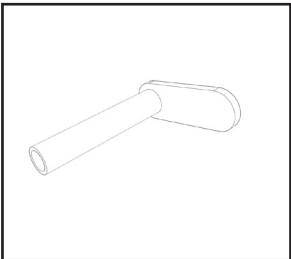

**Position 8**

**Pulley Cart 2.0  
Spacer 1x**

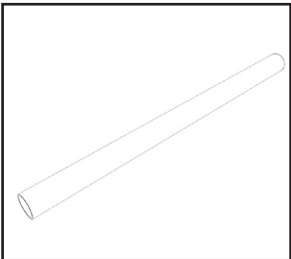

**Position 9**

**Cart Tube 1x**

# Assembly elements:

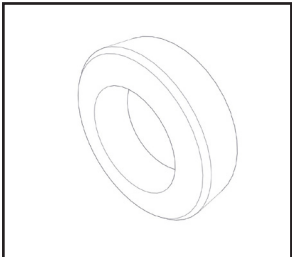

**Position 10**

Spacer fi48 Rubbery  
2x

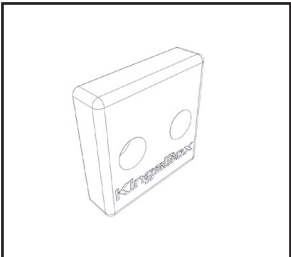

**Position 11**

Rubber Pad 1x

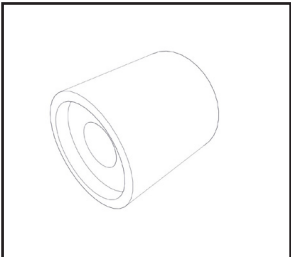

**Position 12**

Pulley Bush fi25



**Position 13**

Cable Ending Ball 1x

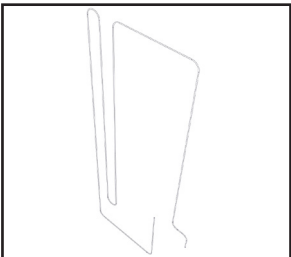

**Position 14**

Cable 10,5m 1x

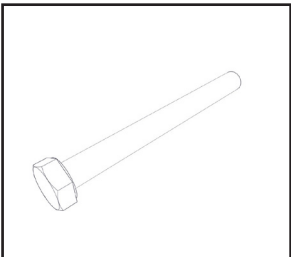

**Position 15**

M10x100

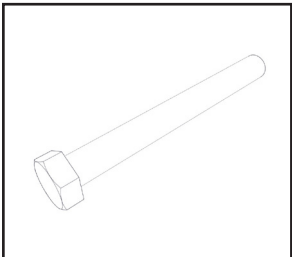

**Position 16**

M10x110

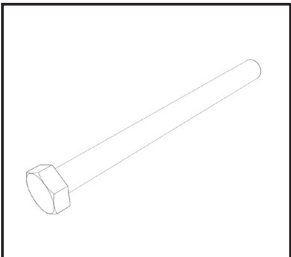

**Position 17**

M10x120

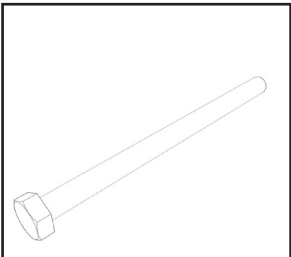

**Position 18**

M8x120

# Assembly elements:

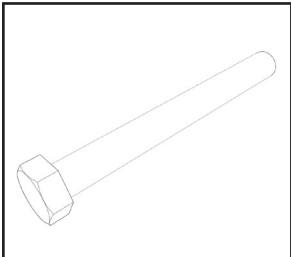

**Position 19**

**M12x110**

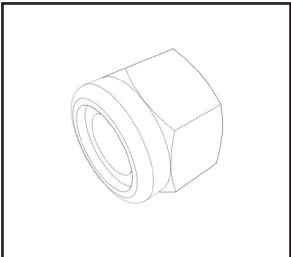

**Position 20**

**Nut M10**

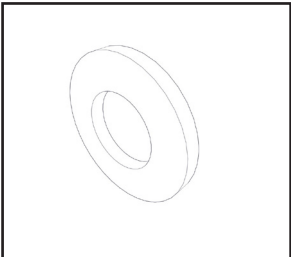

**Position 21**

**Washer M10**

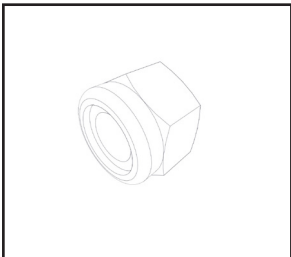

**Position 22**

**Nut M8**

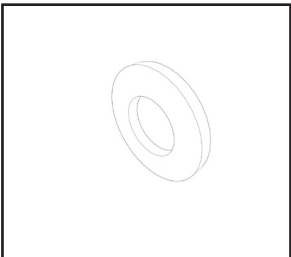

**Position 23**

**Washer M8**

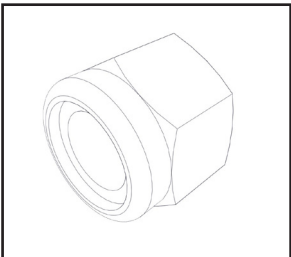

**Position 24**

**Nut M12**

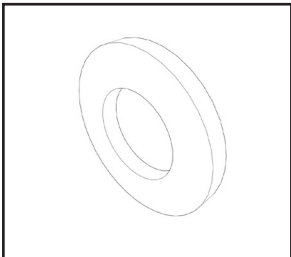

**Position 25**

**Washer M12**

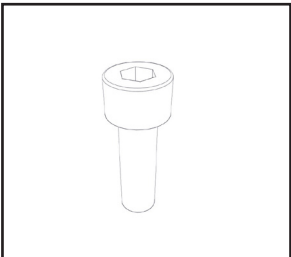

**Position 26**

**M8x25**

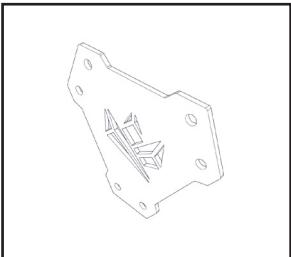

**Position 27**

**CCO Connecting  
Plate 2x**

# Assembly elements:

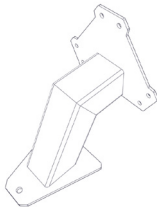

**Position 28**

**CCO Leg 2x**

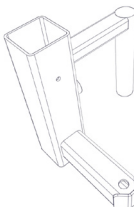

**Position 29**

**CCO Height Adj.  
Trolley 1x**

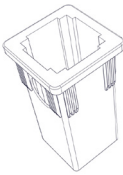

**Position 30**

**Profile Guide Rail 40-  
60 2x**

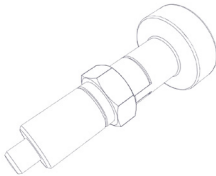

**Position 31**

**Index Plunger  
M16x1,5 1x**



**Position 32**

**Cable Termination  
Thread 1x**

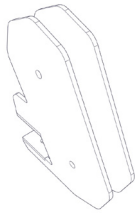

**Position 33**

**CCO Pulley Cart 1x**



**Position 34**

**CCO Height Adj. Col-  
umn 1x**



**Position 35**

**Bushing f14-10 2x**

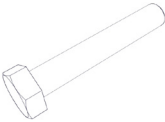

**Position 36**

**M10x60**

# Assembly elements:

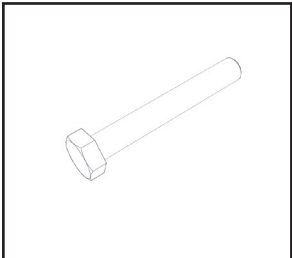

**Position 37**

**M10x70**

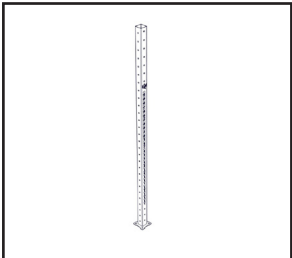



**Position 38**

**Upright 2500**

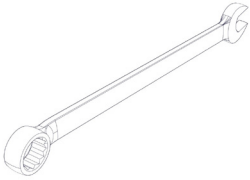

# Tools needed:

<b>Wrench 19</b>
<b>2X</b>



<b>Wrench 17</b>
<b>2x</b>

<b>Wrench 13</b>
<b>2x</b>

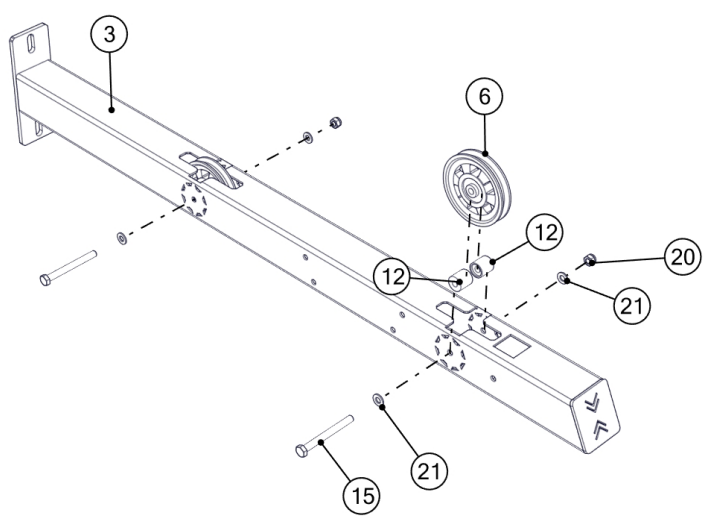

<b>Allen Key 6</b>
<b>1x</b>

# Assembly instruction:

## STEP: 1

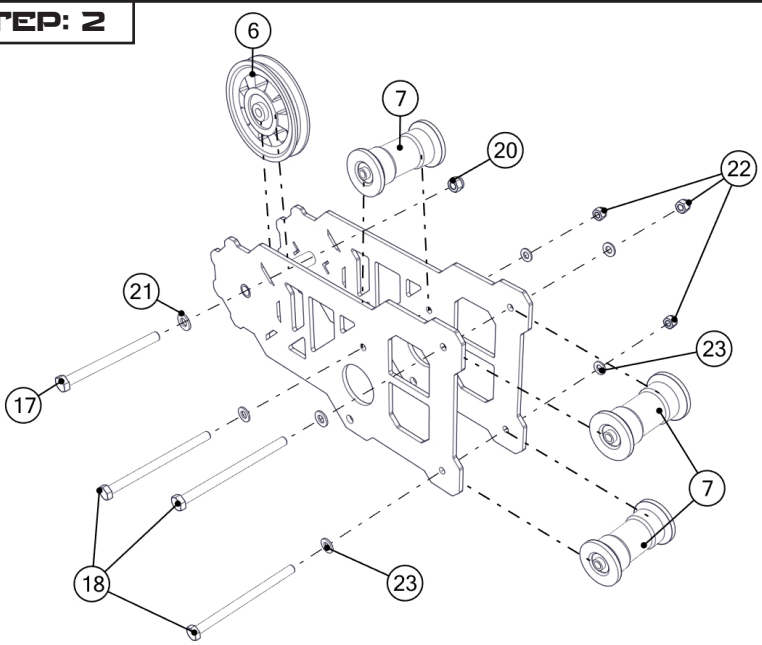

## STEP: 2



# Assembly instruction:

## STEP: 3

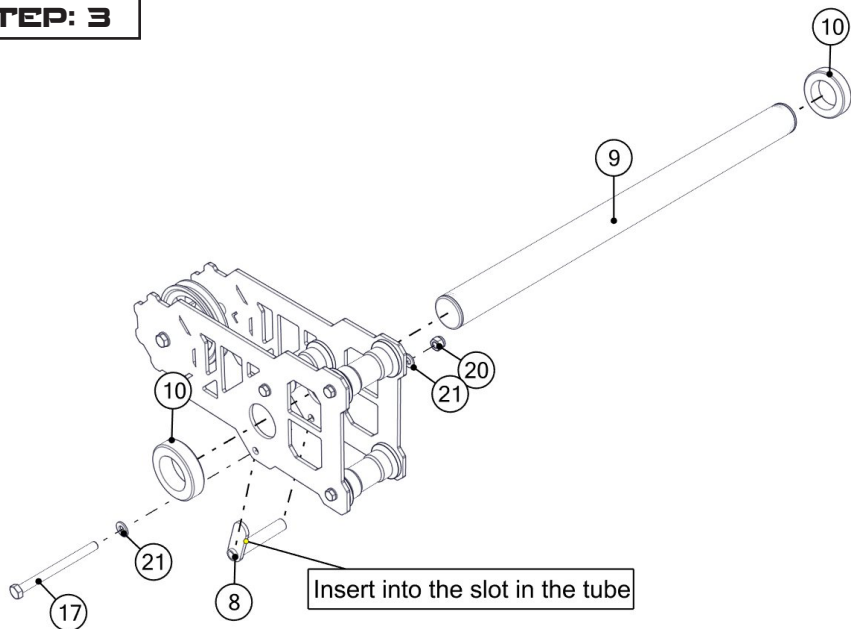

## STEP: 4

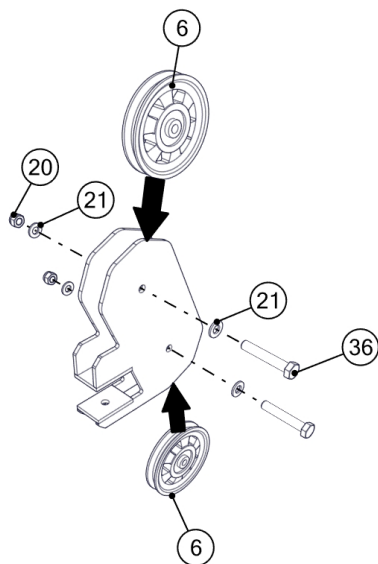

# Assembly instruction:

## STEP: 5

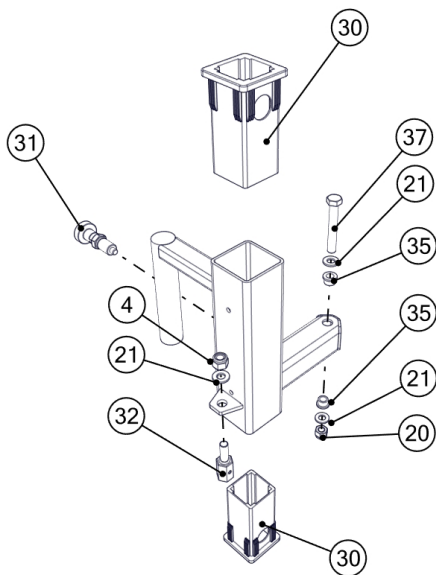

## STEP: 6

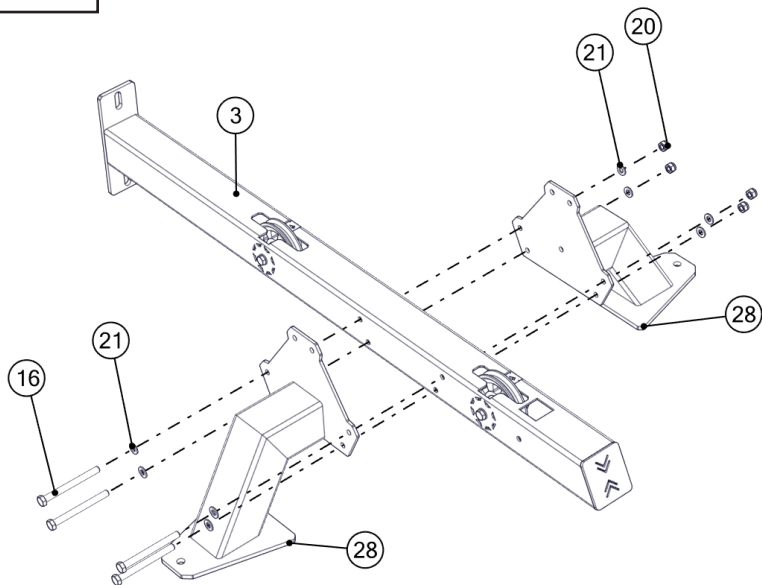

# Assembly instruction:

## STEP: 7

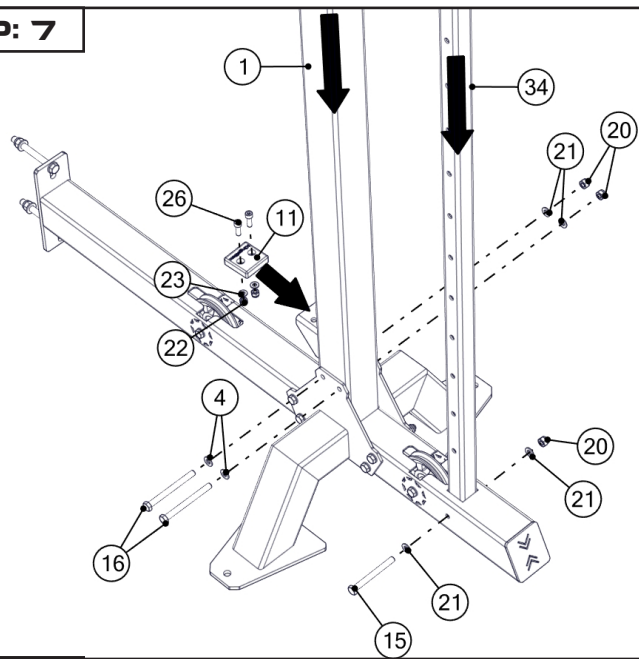

## STEP: 8



# Assembly instruction:

## STEP: 9

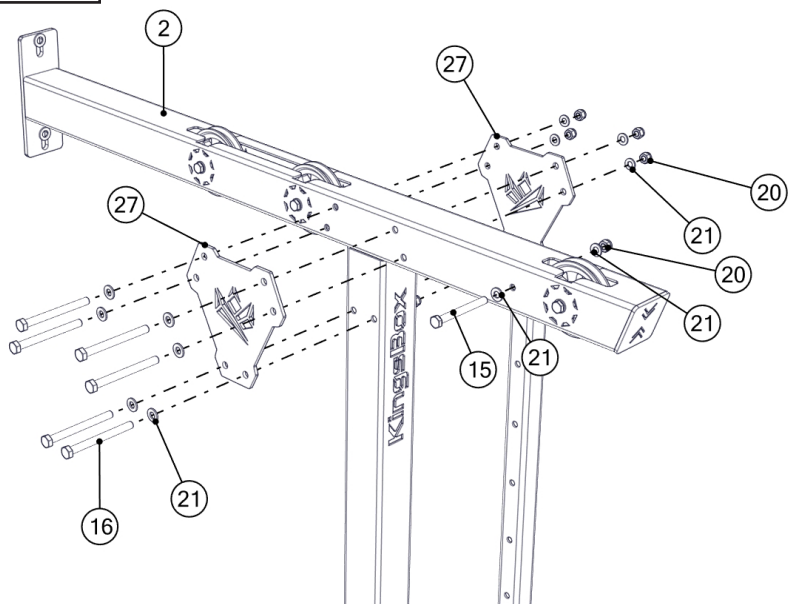

## STEP: 10 Cable Installation

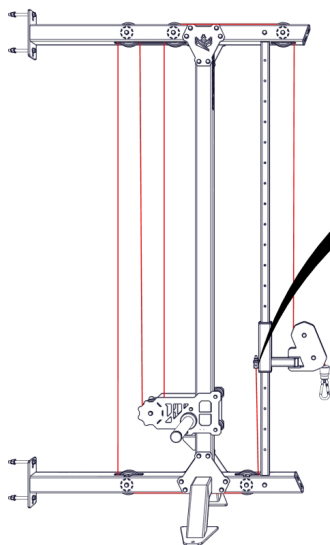

Insert cable end into the Cable Termination element and securely tighten the 3 screw pins. Then guide the cable acc. to the picture.

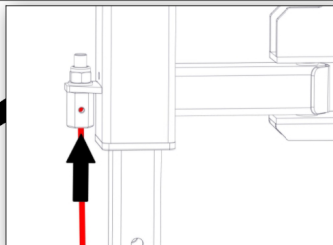

# Assembly instruction:

## STEP: 11 (The End)

Insert Cable Ending onto the cable and tightly fasten the 3 screw pins.

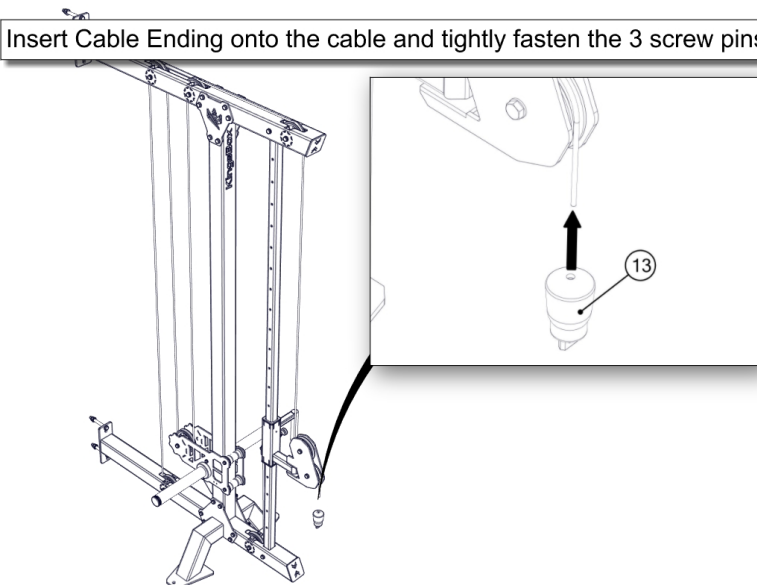

## STEP: 12 - Freestanding version

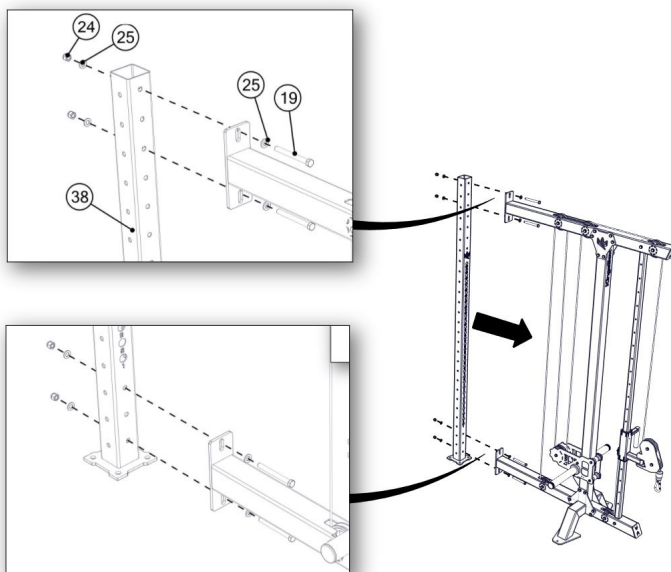

## Note:

Free area around the training equipment should be  $>0,6\text{m}$  than the training area in the direction from which the equipment is accessed.

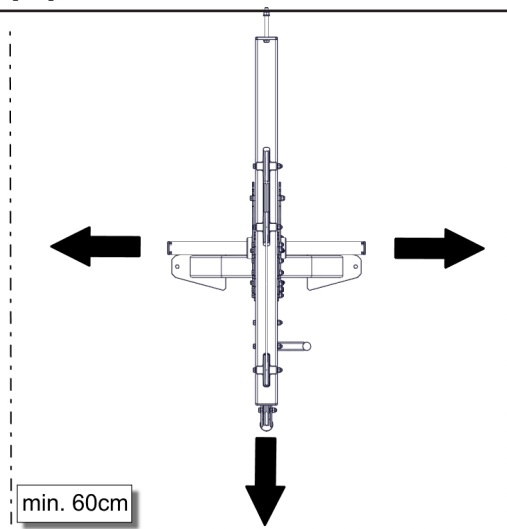

### Max. loading / training mass:

Max. training load 80kg (40kg/sleeve)

